

## Installing the Batteries

The SM-7000B/W optical mouse uses two AAA alkaline batteries.

### Installing Batteries in the Mouse

Step 1. Open the battery compartment

Step 2. Insert the batteries as shown inside the battery compartment.

Step 3. Replace the cover.

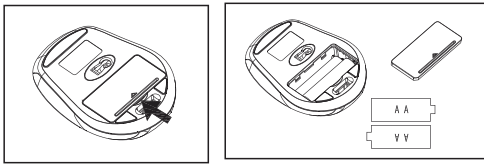

## Connecting the Receiver

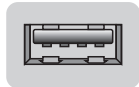

USB Port

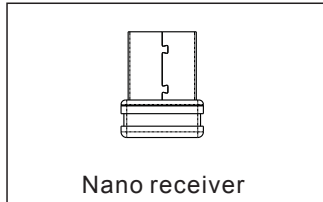

Nano receiver

1. Connect the USB plug **ONLY** to USB port of the computer.

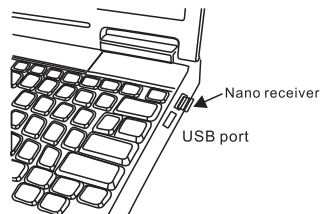

Nano receiver  
USB port

## DPI Function

Your optical mouse 4D buttons mouse is provided with 1000 & 1600 dpi switch.

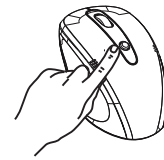

DPI Switch

## Power-Save function:

\* This mouse is equipped with Traveling-Power-Save function. When you are traveling with this mouse, the LED of the mouse will be switched off automatically for the purpose of power-save, but the pre-condition is that the receiver is disconnected with your notebook or PC.

\* when your mouse no any click or scroll or moving, the mouse will come to sleep state for the economize after about 30 minutes, for the wake up, you can click any button for this

## Restoring factory default settings

When you find this set doesn't work, you can make the mouse in working condition by restoring the mouse back to factory default settings.

- 1: check the battery volume is normal; if the battery is used out, please replace new batteries.
- 2: press the right button and middle button (under the scroll wheel) simultaneously; then
- 3: insert the nano receiver onto the USB port of PC or notebook.

NEXUS

# SM-7000 B/W Instruction Manual

Silent Optical 2.4Ghz Mouse

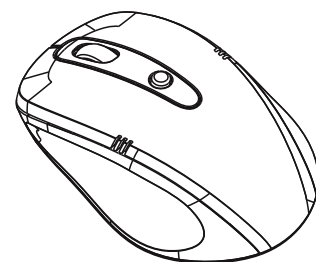

CAUTION: To use this device properly, please read the user's guide before installation.